

# AUTISM CONNECT 2024

*Bringing together the autism community for a day filled with connections, support, and understanding!*

Follow us! @SCDDSN



South Carolina  
Department of Disabilities  
and Special Needs



THE  
CAN  
CENTER

# Message from the DDSN Autism Director

I am thrilled to extend a warm welcome to all our attendees and exhibitors participating in this year's AutismConnect conference. Your presence signifies a shared commitment to enhancing the lives of individuals diagnosed with Autism and their families.

In collaboration with the University of South Carolina's Carolina Autism and Neurodevelopment (CAN) Research Center, we are taking one day to embark on a journey filled with learning, sharing, and community building. Our event is designed to be a comprehensive resource, providing valuable insights into the latest trends, research, and services available to support those with Autism.

To our esteemed exhibitors and sponsors, thank you for your invaluable support and for sharing your expertise, services, and resources with our community. Your contributions enrich our collective understanding and capacity to help those who need our services.

To our dedicated attendees, including experts, caregivers, family members, and all those interested in autism support, your participation today is the heartbeat of this event. Your engagement and eagerness to learn and connect are what make AutismConnect a meaningful and transformative experience.

Together, we will explore a wide range of topics, engage in enriching discussions, and foster connections that will continue to inspire and drive progress in our communities. Today, we can all play a role in making our community better for our loved ones on the spectrum.

Thank you for joining us at AutismConnect2024. Let's make this a memorable and impactful event for everyone involved!

**Stephanie Turner**  
**Autism Division Director**

South Carolina Department of Disabilities and Special Needs



**STEPHANIE TURNER**



# Floorplans

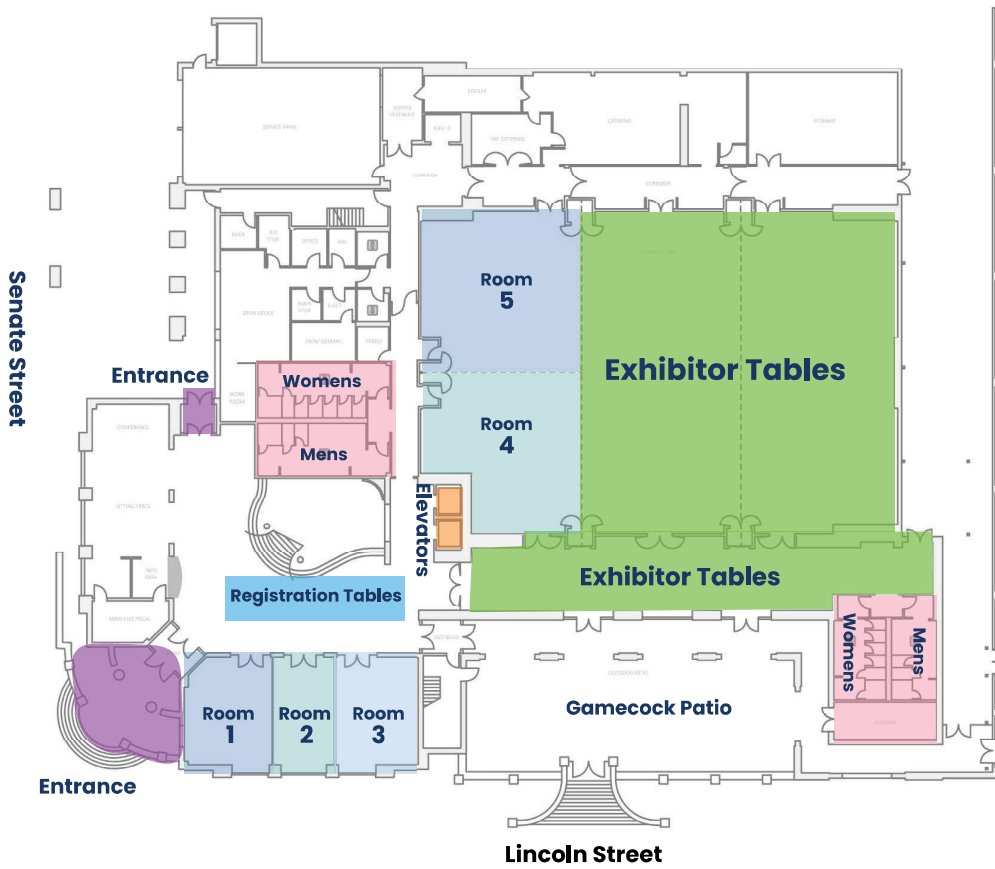

**Level One**

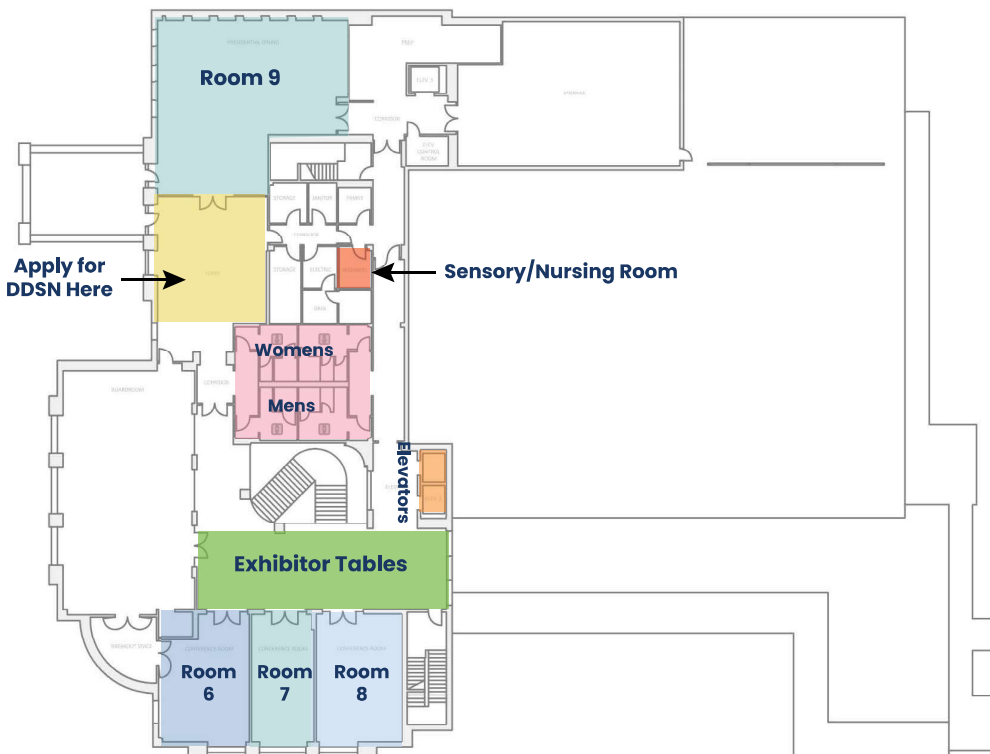

**Level Two**

# Session One (9:30am – 10:30am)

## Dispelling the Common Myths of Working While Receiving Social Security Benefits

**Amber Lydford**

– South Carolina Vocational Rehabilitation

### Room 3

Many parents, caretakers, advocates, and individuals are unaware of the benefits of working while getting SSI or SSDI, the application process, age 18 redeterminations, TEFRA Medicaid, and so much more.

## SC Parents: Empowering Parents & Nurturing Kids

**Brittany Crowley, MPA**

– Children's Trust of South Carolina

### Room 9

Children's Trust of South Carolina has created a bevy of robust resources for parents and caregivers. Come learn how your organization can join the SC Parent Community.

## Mental Health Treatment (CBT) and Autism Spectrum Disorder

**Christopher Moylan, Psy.D. – PRISMA**

### Room 5

Teens with ASD often face anxiety and depression. Intervention for ASD typically includes behavioral therapy like ABA and social skills programs. This presentation focuses on adapting CBT for ASD.

## College Ready?

**Tom Beeson, Ed.S. – Clemson University**

### Room 2

Many students and parents are unsure about college readiness. In this workshop, we will consider skills that are often essential, ways to promote success in college, and parental and student roles and responsibilities.

## Preschool Suspension and Expulsion: Shared Definitions and Next Steps

**Heather Googe, Ph.D.**

**& Meghan Trowbridge, LISW-AP, CBIST**

South Carolina Child Care Inclusion Collaborative

### Room 4

Learn about addressing preschool suspension or expulsion in South Carolina and supporting the workforce to reduce these practices in early childhood settings.

## Cultivating Compassionate Connections: A Guide for Caregivers and Professionals

**Jacqui Williams, M.S., BCBA – Meaningful Milestones**

### Room 1

Explore strategies for empathy, kindness, and understanding. Ideal for caregivers and professionals, focusing on communication, compassion, and supportive environments.

## Supporting Transition and Employability Skills through a Plant Nursery Business and AI

**Lisa Kershaw, Ed.D. – Joyful Souls Heirloom Nursery**

### Room 6

Learn about supporting transition skills through home-based businesses, aiding individuals with autism, and enhancing skills with AI; experience a mother and son's venture in Columbia supporting employability and social needs.

## Unveiling Excellence: Navigating Impact Inclusivity and Empowerment Through Innovation and Leadership

**Marcus McClearn, M.Ed. – Arc of the Midlands**

### Room 8

Discover key insights, accomplishments, and vision of IDD/RD advocates, emphasizing impact, inspiration, inclusivity, and collaborative strategies shaping success.

## South Carolina Equipment Distribution Program: Products to Make Communication Easier

**Quantella Perry**

– South Carolina Equipment Distribution Program

### Room 7

Learn how SCEDP partners with organizations and professional to help speech impaired individuals with autism. Apply for a free iPad and speech app!

# Session Two (10:45am – 11:45am)

## Transportation: Creating Access to Independence

**Ali Ruegamer** – able South Carolina

### Room 4

This presentation will highlight barriers to transportation for individuals with disabilities in South Carolina, emphasizing its importance and options available in the Midlands.

## DDSN 101 and Transition Services

**Carrie Walker, Angela McGinty, MS, & Octavia Graham, MS**

– SC Department of Disabilities and Special Needs

### Room 9

DDSN Transition Coordinators will present who DDSN serves, DDSN services, how to become eligible with DDSN, the roles of Transition Coordinators, and resources that are available for you to use today!

## MUSC SPARK and Autism Research Opportunities in South Carolina

**Catherine Bradley, Ph.D., Jessica Bradshaw, Ph.D., Abby Hogan, Ph.D., & Robert Hock Ph.D., LiSW-CP**

– Medical University of South Carolina

### Room 7

This presentation will cover information about the SPARK study at MUSC and other research opportunities available throughout South Carolina.

## Continuum of Care: Serving Children with Serious Emotional or Behavioral Health Diagnoses

**Gregory Wright, LPC** – Continuum of Care

### Room 1

Learn how the COC program in South Carolina helps children with behavioral health issues stay in their homes, schools, and communities using the team-based High Fidelity Wraparound Model.

## The Palmetto ABLE Savings Program: Saving for the Future

**Karen Crider**

– Palmetto ABLE Savings Program, State Treasurer's Office

### Room 3

Palmetto ABLE accounts help individuals with disabilities save without losing benefits. This presentation covers federal and state legislation, eligibility, opening accounts, benefits, and more.

## The Nuts & Bolts of a Genetics Evaluation for Autism Spectrum Disorder

**Katy Drazba, MPH, MS, CGC**

– Greenwood Genetics Center

### Room 2

Explore the essentials of genetic evaluations for autism spectrum disorders. This talk will cover the basics of the evaluation, including dysmorphology, genetic testing, associated conditions, family history red flags, and outlining future treatment opportunities.

## Enhancing Family Engagement in IEP Meetings: A Vital Partnership

**Sally Baker, M.Ed., CCLS**

– Family Connection of South Carolina

### Room 6

This presentation highlights the importance of family involvement in Individualized Education Program (IEP) meetings to help students succeed through collaboration and effective communication.

## Meltdowns and Tantrums: Helping Parents Support Emotion Regulation in Toddlers with Autism

**Sara Edmunds, Ph.D.** – University of South Carolina

### Room 5

Parents will learn strategies to manage autism-related tantrums in toddlers and promote coping skills.

## Common Misconceptions about the College Experience for Individuals with Intellectual Disability

**Shayla Anderson, M.Ed.**

– SC Inclusive Postsecondary Education Consortium

### Room 8

College IS possible for individuals with intellectual disability through inclusive programs in South Carolina that focus on academic, functional domains, affording college, transitioning preparation, and necessary skills for IPSE success.

# Session Three (1:00pm – 2:00pm)

## Parent and Researcher Perspectives on Parent–Peer Support Programs

**Abigail Mojica, M.A.T., Robert Hock, Ph.D., LISW–CP, Anja Wilson, BA, Cortney Heuer, & MSW, Laura Shugart Sigman** – University of South Carolina

### Room 7

Parent–peer support programs improve caregiver mental health, social support, and service navigation skills for families of children with ASD, according to a study in South Carolina.

## Understanding Behavior

**Alexandra Newcomb, M.Ed., BCBA** – Behavior Co

### Room 5

Understanding Behavior: Why does behavior happen?

## Making the “Transition” from Special Education to Postsecondary Education and Employment

**Amanda Hess, J.D.** – Disability Rights South Carolina

### Room 1

The presentation will cover transition services for students with IEPs and emphasize the need for students to request accommodations before leaving high school.

## Guardianship and Alternatives

**Anna Maria Conner, J.D.**

– Disability Rights of South Carolina

### Room 4

Objectives include defining guardianship, exploring its impact on families and care recipients, and discussing supportive alternatives that empower individuals to decide.

## Making Connection through Special Olympics

**Barbara Oswald** – SC Special Olympics

### Room 8

This session will showcase Special Olympics opportunities that promote active lifestyles, healthy relationships, and meaningful inclusion for individuals with disabilities, targeting caregivers and professionals.

## Investing in our Future: Infant and Early Childhood Mental Health

**Mackenzie Soniak, Psy.D.**

– South Carolina Infant Mental Health Association

### Room 2

Learn about the collaborative SC Infant Mental Health Association provides professional development opportunities, resources, and services for infant and early care professionals and families in SC.

## Fine-Tuning Tools to Help Providers Support Emotion Regulation in Very Young Autistic Children

**Sara Edmunds, Ph.D.** – University of South Carolina

### Room 9

Professionals will learn evidence based strategies to reduce autistic meltdowns in toddlers, addressing common family concerns.

## Homeschooling the Child with Special Needs

**Susan Blackwell**

– Homeschooling the Special Needs Child

### Room 3

We'll cover legal aspects, learner types, grading options, and help you choose the best for your student by guiding you to helpful resources for your homeschooling journey.

## Clarifying Misconceptions About Special Education in Charter Schools

**Wendy Ward, MAT**

– South Carolina Public Charter District

### Room 6

School choice is on the rise in South Carolina. Historically, misconceptions exist regarding charter schools and special education. This session will explain student enrollment, funding, accountability, teacher licensure, and programming as it pertains to special education in charter schools

# Exhibitor Info



- [ablekids.com](http://ablekids.com)
- [info@ablekids.com](mailto:info@ablekids.com)
- 1084 Lake Murray Blvd, Irmo, SC 29063
- 706-842-5330

ABLE provides intensive ABA therapy for children with autism in a preschool-like environment.



- [babcockcenter.org](http://babcockcenter.org)
- [info@babcockcenter.org](mailto:info@babcockcenter.org)
- 2725 Banny Jones Ave., West Columbia, SC 29170
- 803-799-1970

The Babcock Center provides residential and vocational training for people with autism.



- [aboutplaysc.com](http://aboutplaysc.com)
- [info@aboutplaysc.com](mailto:info@aboutplaysc.com)
- 2211 Alpine Road Ext., Columbia, SC 29223
- 1-800-289-7012

About Play offers Early Intervention Services in 44 counties of South Carolina for infants and children up to six years old. They provide Family Training and Service Coordination to teach children through play and everyday routines, promoting social, emotional, communication, motor, adaptive, and cognitive development.



- [scdhhs.gov](http://scdhhs.gov)
- [BabyNet@scdhhs.gov](mailto:BabyNet@scdhhs.gov)
- 1801 Main Street, Columbia, SC 29201
- 1-866-512-8881

BabyNet is South Carolina's program providing services to infants and toddlers aged 0-3 years with developmental delays or conditions like autism.



- [agingwithflair.org](http://agingwithflair.org)
- [awreferral@agingwithflair.biz](mailto:awreferral@agingwithflair.biz)
- 219 Gerald Drive, Simpsonville, SC 29681
- 864-757-9920

Early Intervention company in upstate offers BabyNet and DDSN plans for children, including assessments, therapy, and school transitions.

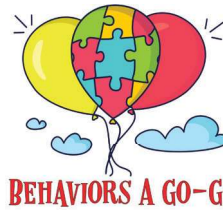

- [behaviorsagogo.com](http://behaviorsagogo.com)
- [referral@bhagogo.biz](mailto:referral@bhagogo.biz)
- 219 Gerald Drive, Simpsonville, SC 29681
- 864-757-9918

Behaviors A Go-Go offers comprehensive ABA treatment, addressing cognitive, communicative, social, emotional, and adaptive functioning, implementing individualized care plans for meaningful, positive changes for each child and their family.



- [allcaregivers.net](http://allcaregivers.net)
- [info@allcaregivers.net](mailto:info@allcaregivers.net)
- 4727C Sunset Blvd, Lexington, SC 29072
- 803-951-0771

AllCaregivers provides personal care aides to assist with activities of daily living such as bathing, dressing, meal preparation, and more. Also provides aides for respite care.



- [bgr8martialarts.com](http://bgr8martialarts.com)
- [bgr8ma@gmail.com](mailto:bgr8ma@gmail.com)
- 130 Hunter Village Drive, Suite C, Irmo, SC 29063
- 803-730-0324

BGR8 Martial Arts offers a family-oriented program for children with autism, enhancing coordination, physical conditioning, and social skills through a safe environment.



- [scautism.org](http://scautism.org)
- [scas@scautism.org](mailto:scas@scautism.org)
- 806 12th Street, West Columbia, SC 29169
- 803-750-6988

SCAS is a non-profit organization in South Carolina dedicated to assisting individuals with autism spectrum disorders through initiatives like Parent-School Partnership, Case Management, Information and Referral, and Advocacy.



- [brightstartsc.com](http://brightstartsc.com)
- [columbia@brightstartsc.com](mailto:columbia@brightstartsc.com)
- 720 Gracern Rd, Suite 450, Columbia, SC 29210
- 803-929-1112

Bright Start offers early intervention and case management services for individuals on the autism spectrum, enhancing quality of life through compassion, excellence, integrity, and leadership.



- [caringhealthcaresc.com](http://caringhealthcaresc.com)
- [caringinc1995@yahoo.com](mailto:caringinc1995@yahoo.com)
- 6B Bush River Care, Columbia, SC 29210
- 803-772-2231

Provides in-home care and support for the autistic community, offering assistance with hygiene, grooming, supervision, companionship, meal prep, and housekeeping, while also providing parental downtime.



- [comop.org](http://comop.org)
- [craig.scott@comop.org](mailto:craig.scott@comop.org)
- 16 Woodcross Drive, Columbia, SC 29212
- 803-750-8998

Community Options promotes disability inclusion through residential services, day programs, social enterprises, high school transition programs, and specialized programs, enhancing accessibility and collaboration with community partners.



- [sc.edu](http://sc.edu) (Search Carolina Autism and Neurodevelopment Research Center)
- [can@sc.edu](mailto:can@sc.edu)
- 1800 Gervais Street, Columbia, SC 29201

USC's Carolina Autism and Neurodevelopment Research Center is an interdisciplinary hub for research and education on autism and neurodevelopmental disorders, led by Jane Roberts and Jeff Twiss.



- [prismahealthchildrens.org](http://prismahealthchildrens.org)
- 9 Medical Park Drive, Suite 210 Columbia, SC 29203
- 803-434-6598

At Prisma Health Developmental Pediatrics, we provide consultations and evaluations for children with developmental, academic or behavioral difficulties. We believe in taking an interdisciplinary approach to helping children with disabilities and their families thrive!

## Center for Disability Resources

SCHOOL OF MEDICINE  
UNIVERSITY OF SOUTH CAROLINA

- [sc.edu](http://sc.edu) (Search Center of Disability Resources)
- [david.rotholz@uscmed.sc.edu](mailto:david.rotholz@uscmed.sc.edu)
- 8301 Farrow Road, Columbia, SC 29208
- 803-935-7819

Our center bridges university-community relations for intellectual, developmental, and related disabilities, providing interdisciplinary training, technical assistance, community services, research, and dissemination services.



- [www.scpartnershipsforinclusion.org](http://www.scpartnershipsforinclusion.org)
- [scpi@mailbox.sc.edu](mailto:scpi@mailbox.sc.edu)
- 1530 Wheat Street, Columbia, SC 29208
- 803-429-0519

South Carolina Partnerships for Inclusion (SCPI) is an early childhood technical assistance (TA) center focused on increasing inclusive opportunities and school readiness for preschool children with disabilities.



- [scinclusion.org](http://scinclusion.org)
- [scic@mailbox.sc.edu](mailto:scic@mailbox.sc.edu)
- 1530 Wheat Street, Columbia, SC 29208
- 803-777-8483

The South Carolina Child Care Inclusion Collaborative offers tailored training and technical support to child care providers to facilitate the inclusion of children with disabilities or developmental delays.



- [disabilityrightssc.org](http://disabilityrightssc.org)
- [info@disabilityrightssc.org](mailto:info@disabilityrightssc.org)
- 3710 Landmark Drive, Suite 208, Columbia, SC 29204
- 866-275-7273

DRSC, South Carolina's designated Protection and Advocacy system, safeguards and promotes the rights of people with disabilities through free services, including legal support, self-advocacy training, and system change.



- [scparents.org](http://scparents.org)
- [bcrowley@scchildren.org](mailto:bcrowley@scchildren.org)
- 1330 Lady Street Suite 310, Columbia, SC 29201
- 803-733-5430

SC Parents, developed by Children's Trust of South Carolina, provides parents and caregivers with social care resources, trusted advice, and statewide parent-to-parent support.



- [epworthchildrenshome.org](http://epworthchildrenshome.org)
- [erodgers@epworthsc.org](mailto:erodgers@epworthsc.org)
- 2900 Millwood Avenue, Columbia, SC 29205
- 803-256-7394

Epworth's Counseling Center offers licensed therapists for mental, behavioral, and substance use concerns, while its Early Intervention Center focuses on children with developmental delays and disabilities.





- [familyconnectionsc.org](http://familyconnectionsc.org)
- [info@familyconnectionsc.org](mailto:info@familyconnectionsc.org)
- 1800 Saint Julian Place, Suite 104, Columbia, SC 29204
- 803-252-0914

Family Connection of South Carolina (FCSC) is the state's Parent Training and Information Center, providing peer support, training, outreach, and advocacy for families with disabilities.

- [mksempower.com](http://mksempower.com)
- [Bemighty@mksempower.com](mailto:Bemighty@mksempower.com)
- 300 Rice Meadow Way, Suite 200, Columbia SC 29229
- 803-866-5439



Mighty Kidz Services offers ABA and Speech Therapy programs for neurodivergent children aged 2-6, including preschool prep, school programs, and individualized after-school services in various settings.



- [greenvillelearningcollective.com](http://greenvillelearningcollective.com)
- [Sunny@greenvillelearningcollective.com](mailto:Sunny@greenvillelearningcollective.com)
- 122 Memorial Drive, Greer, SC 29650
- 864-451-2563

Greenville Learning Collective provides speech-language evaluations, therapy, and educational advocacy for autistic individuals and co-occurring disabilities, while also offering individualized therapy and mental health services.



- [npusa.org](http://npusa.org)
- [nponline@npitx.org](mailto:nponline@npitx.org)
- Online Live Virtual Training Program
- 972-971-1380

nP Online provides virtual Art and Design training for students, fostering creativity, work readiness, and social interest-based clubs, allowing them to apply knowledge and apply their skills.



- [homeschoolingthespecialneedschild.com](http://homeschoolingthespecialneedschild.com)
- [Sblackwelltesting@gmail.com](mailto:Sblackwelltesting@gmail.com)
- 1162 West Fairhill Drive, West Columbia, SC 29170
- 803-429-3899

We assist families with all homeschooling services. These include curricular choices, implementing accommodations, testing services, and much more!



- [onewell.org](http://onewell.org)
- [southcarolina@onewell.org](mailto:southcarolina@onewell.org)
- 7 Arleys Way, Suite 102A, Bluffton, SC 29910
- 843-781-8927

OneWell of South Carolina, LLC offers IHCS and nursing services, focusing on a unique participant-centered approach to help those stay home as long as possible.



- [justiceworksbc.org](http://justiceworksbc.org)
- [richlandreferrals@justiceworksbc.org](mailto:richlandreferrals@justiceworksbc.org)
- 2711 Middleburg Drive, Suite 212, Columbia, SC 29204
- 803-234-6134

JusticeWorks BehavioralCare offers a range of services including individual and family therapy, psycho-social skills, behavior modification, and parenting skills, aiming to support personal growth and functioning.



- [PalmettoABLE.com](http://PalmettoABLE.com)
- [Karen.Crider@sto.sc.gov](mailto:Karen.Crider@sto.sc.gov)
- 1200 Senate Street, Suite 214, Columbia, SC 29201
- 803-734-0725

The Palmetto ABLE Savings Program provides tax-advantaged savings and investment accounts for people with disabilities, ensuring eligibility for critical needs-based benefits without jeopardizing their financial stability.



- [lexrich5.org](http://lexrich5.org)
- [spedrecords@lexrich5.org](mailto:spedrecords@lexrich5.org)
- 1020 Dutch Fork Road, Irmo, SC 29063
- 803-476-8222

District Five of Lexington and Richland Counties Special Education Services offers free public education to children with disabilities, utilizing over 200 trained teachers and specialists to meet individual needs.



- [rldsn.org](http://rldsn.org)
- [RLDSNB@aol.com](mailto:RLDSNB@aol.com)
- 301 Greystone Blvd., Columbia, SC 29210
- 803-252-5179

The Richland/Lexington Disabilities and Special Needs Board provides quality services to individuals with disabilities, focusing on individualized needs and identifying appropriate providers.



- [coc.sc.gov](http://coc.sc.gov)
- [trenay.dukes@childadvocate.sc.gov](mailto:trenay.dukes@childadvocate.sc.gov)
- 810 Dutch Square Blvd., Suite 390, Columbia, SC 29210
- 803-737-0640

Continuum of Care, a division of SC Department of Children's Advocacy, offers High Fidelity Wraparound for children with serious emotional, behavioral, and psychiatric issues.



- [ddsn.sc.gov](http://ddsn.sc.gov)
- [stephanie.turner@ddsn.sc.gov](mailto:stephanie.turner@ddsn.sc.gov)
- 3440 Harden Street, Columbia, SC 29203
- 1-800-289-7012

SC DDSN's Autism Division aims to improve quality of life for individuals with autism spectrum disorder, promoting early intervention, diagnosis, treatment, and support.



- [scdhec.gov](http://scdhec.gov)
- [biddleeb@dhec.sc.gov](mailto:biddleeb@dhec.sc.gov)
- 2100 Bull Street, Columbia, SC 29201
- 803-898-0871

A program offering comprehensive services for children with special healthcare needs, promoting their health and well-being.



- [ed.sc.gov](http://ed.sc.gov)
- [cfitts@ed.sc.gov](mailto:cfitts@ed.sc.gov)
- 1919 Blanding Street, Columbia, SC 29201
- 803-734-1280

The OSES works to build local capacity to improve educational results and functional outcomes for children with disabilities in the state and to ensure that local education agencies (LEAs) meet program requirements under IDEA.



- [scphilharmonic.com](http://scphilharmonic.com)
- [info@scphilharmonic.com](mailto:info@scphilharmonic.com)
- 1704 Main Street, Suite 100, Columbia, SC 29201
- 803-771-7937

The South Carolina Philharmonic's inclusive concert "A Work of Heart" allows audience members to freely experience orchestral music and welcomes sensory-sensitive listeners.



South Carolina  
**DEPARTMENT ON AGING**

- [aging.sc.gov](http://aging.sc.gov)
- [info@aging.sc.gov](mailto:info@aging.sc.gov)
- 1301 Gervais Street, Suite. 350, Columbia, SC 29201
- 803-734-9900

We provide support and resources for programs that help aging citizens and adults with disabilities live independently.



- [sccharter.org](http://sccharter.org)
- [info@sccharter.org](mailto:info@sccharter.org)
- 1824 Barnwell Street, Columbia, SC 29201
- 803-734-8322

The SC Public Charter School District authorizes 39 charter schools across the state, serving 18,500 students with about 17% being students with exceptionalities. SCPCSD prides itself in being a champion for all students.



SOUTH CAROLINA  
Developmental Disabilities Council

- [scddc.sc.gov](http://scddc.sc.gov)
- [Valarie.bishop@admin.sc.gov](mailto:Valarie.bishop@admin.sc.gov)
- 1205 Pendleton Street, Suite 372, Columbia, SC 29201
- 803-734-0465

The Council works towards a comprehensive system that includes community services, individualized support, and other assistance to promote self-determination for individuals with developmental disabilities and their families.



- [schomeschooling.com](http://schomeschooling.com)
- [scaihs@scaihs.org](mailto:scaihs@scaihs.org)
- 613 St. Andrews Road, Columbia, SC 29210
- 803-814-0353

SCAIHS Special Needs department supports exceptional learners with tailored resources and techniques from diverse experts.



- [first5sc.org](http://first5sc.org)
- 636 Rosewood Drive, Columbia, SC 29201
- 803-734-0479

First Five SC offers free resources and services for expecting or raising children, including food assistance, child care, special needs services, and parenting support. Visit [first5sc.org](http://first5sc.org) for more information.



**820 Main Street,  
235C Wardlaw,  
Columbia, SC 29208**

SCIPSEC supports South Carolina college students with disabilities in academics, independent living, socializing, and employment.



**springbrookbehavioral.com**  
**admissions@springbrookbhs.com**  
**One Havenwood Lane,  
Travelers Rest, SC 29690**  
**864-660-6220**

Springbrook Autism Behavioral Health offers compassionate, multidisciplinary care for children and adolescents with autism, providing a nurturing, stable, and therapeutic environment tailored to their unique needs.



**sctalkingbook.org**  
**TBSBooks@statelibrary.sc.gov**  
**1500 Senate Street,  
Columbia SC 29201**  
**803-734-4611**

Talking Book Services offers accessible reading materials for individuals with visual, physical, and print disabilities, including audiobooks, braille, and assistive technology, to improve their reading experience.



**arcsc.org**  
**thearc@arcsc.org**  
**254 Corley Mill Road,  
Lexington, SC 29072**  
**803-748-5020**

We offer statewide case management services and host various programs, including Wings for All, Disability Advocacy Day, Elephant in the Room, and ALERT for first responders.



**scmuseum.org**  
**accessibility@scmuseum.org**  
**301 Gervais Street, Columbia,  
SC 29201**  
**803-898-5033**

The South Carolina State Museum is an innovative institution showcasing South Carolina's diversity, offering monthly Accessibility Mornings, sensory-friendly shows, and a Wellness Room for guests.



**aikentdc.org**  
**director@aikentdc.org**  
**1016 Vaucluse Road,  
Aiken, SC 29801**  
**803-642-8800**

Tri-Development Center of Aiken County, Inc. is a leading provider of services and support for citizens with disabilities, including day, employment, residential, and rep payee services, as well as a commercial bakery.



**musckids.org**  
**sparkautism@musc.edu**  
**135 Rutledge Ave,  
Charleston, SC 29425**  
**843-714-1352**

SPARK, the largest autism study, is a community of families, autistic adults, and researchers, with over 300,000 participants, addressing gaps in research and transforming the field.



**scdmh.net**  
**Mobilecrisis@scdmh.org**  
**2414 Bull Street, Ste 309,  
Columbia SC**  
**833-364-2274**

Mobile Crisis is available 24/7 for mental health emergencies. Services may be provided telephonically, on-site, or via telehealth. The Office of Suicide Prevention provides training, education, and resources for South Carolinians and oversees the implementation of the 988 National Suicide and Crisis Lifeline in SC.



**so-sc.org**  
**acorley@so-sc.org**  
**204 Palmetto Park Blvd,  
Lexington, SC 29072**  
**803-772-1555**

Special Olympics South Carolina offers year-round sports training and competition for children and adults with IDD, promoting physical fitness, courage, joy, and inclusivity in schools and communities.

**THANK YOU**  
**TO ALL OF OUR EXHIBITORS!**

# SPONSORS

## Platinum



**SOUTH CAROLINA**  
Developmental Disabilities Council



Center for  
**Disability Resources**  
SCHOOL OF MEDICINE  
UNIVERSITY OF SOUTH CAROLINA

## Gold



## Silver





South Carolina  
Department of Disabilities  
and Special Needs



THE  
CAN  
CENTER

The South Carolina Department of Disabilities and Special Needs and the UofSC's Carolina Autism and Neurodevelopment Research Center are beyond grateful for the businesses and organizations who donated prizes for **AutismConnect**.

These prizes allow attendees the opportunity to not only walk away with a wealth of knowledge and resources, but possibly with a fun activity, helpful shopping experience, or another awesome gift!

**Again, we say thank you to the following prize donors:**





Stay Tuned For

# AUTISM CONNECT 2025

*April*

---

Follow us on social media for updates!

@SCDDSN











# AUTISM CONNECT

**Find an Exhibitor Win a Prize!**

**B I N G O**

 <b>I.M.P.A.C.T. S.C.</b>	<b>Residential Program</b>	 <b>Developmental Disabilities Council</b>	<b>Assistive Technology Program</b>	 <b>Caring Healthcare</b>
<b>Early Intervention</b>	 <b>DDSN</b>	<b>Employment Support</b>	<b>Personal Care Aid</b>	<b>Education Agency</b>
<b>Applied Behavior Analysis</b>	<b>Disability Library</b>	<b>Free Space</b>	<b>Mental Health</b>	<b>Financial Support</b>
<b>Healthcare</b>	<b>Recreation</b>	<b>Resource Database</b>	 <b>THE CAN CENTER</b> <small>UNIVERSITY OF SOUTH CAROLINA</small>	<b>Autism Evaluators</b>
<b>Case Management</b>	<b>Autism Research</b>	 <b>OneWell</b>	<b>Trainers for Childcare Providers</b>	 <b>Disability Rights</b>

**Show your completed board to registration for a prize.**