

SOUTH CAROLINA COMMISSION ON DISABILITIES AND SPECIAL NEEDS

MINUTES

March 17, 2016

The South Carolina Commission on Disabilities and Special Needs met on Thursday, March 17, 2016, at 10:00 A.M. at the Department of Disabilities and Special Needs Central Office, 3440 Harden Street Extension, Columbia, South Carolina.

The following were in attendance:

COMMISSION

Present:

Bill Danielson, Chairperson
Eva Ravenel, Secretary
Mary Ellen Barnwell
Katherine Davis
Gary Lemel
Vicki Thompson

Absent

Fred Lynn, Vice Chairman

DDSN Administrative Staff

Dr. Buscemi, State Director; Mr. David Goodell, Associate State Director, Operations; Mrs. Susan Beck, Associate State Director, Policy; Mr. Tom Waring, Associate State Director, Administration; Mrs. Tana Vanderbilt, General Counsel (For other Administrative Staff see Attachment 1 – Sign In Sheet).

Guests

(See Attachment 1 Sign-In Sheet)

Coastal Regional Center (via videoconference)

(See Attachment 2 Sign-In Sheet)

Georgetown County DSN Board

(See Attachment 3 Sign-In Sheet)

Pee Dee Regional Center (via videoconference)

(See Attachment 4 Sign-In Sheet)

Pickens County DSN Board (via videoconference)

(See Attachment 5 Sign-In Sheet)

Whitten Regional Center (via videoconference)
(See Attachment 6 Sign-In Sheet)

York County DSN Board (via videoconference)
(See Attachment 7 Sign-In Sheet)

News Release of Meeting

Chairperson Danielson called the meeting to order and Commissioner Ravenel read a statement of announcement about the meeting that was mailed to the appropriate media, interested persons, and posted at the Central Office and on the website in accordance with the Freedom of Information Act.

Invocation

Commissioner Barnwell gave the invocation.

Adoption of the Agenda

The Commission adopted the March 17, 2016 Meeting Agenda by unanimous consent. (Attachment A)

Approval of the Minutes of the February 18, 2016 Commission Meetings

The Commission approved the February 18, 2016 Commission Meeting minutes with a change by unanimous consent.

Public Input

Ms. Deborah McPherson of Columbia spoke; Mr. Jerry Mize, Executive Director, Oconee County DSN Board, spoke on behalf of a group/organization; Ms. Kathleen Roberts spoke on behalf of the Whitten Center Parents' Club; Dr. Gerald Bernard, Executive Director, Charles Lea Center spoke on behalf of the SC Human Services Providers Association.

Commissioners' Update

Commissioners Thompson, Ravenel and Danielson spoke of events in their districts.

Disability Advocacy Day

Ms. Margie Williamson, Executive Director of the ARC of South Carolina, and Ms. Connie Coleman, President of SC IMPACT, the statewide self-advocate organization, spoke about the Disability Advocacy Day event that took place on March 2, 2016 at the South Carolina Statehouse.

Ms. Williamson presented a plaque to Ms. Coleman honoring her for her outstanding leadership in support of the advocacy network. Mr. Williamson stated it is a very well deserved award.

Consumer Recognition/Employment Showcase

Dr. Buscemi introduced Mr. Terry Rogers, Executive Director, CHESCO Services. Mr. Rogers, Ms. Annmarie Whyte, Walmart Manager , and Mr. Gabe Watson of CHESCO Services spoke of CHESCO's employment initiatives with Walmart. Mr. Watson introduced Mr. Sammie McAlilly III, a consumer employed with Walmart that recently was honored as the Cheraw Citizen of the Year by the Cheraw Chamber of Commerce. He also received the Sam Walton Award which is awarded to only a few of the 2.1 million Walmart employees. Mr. McAlilly not only serves as a role model employee but also as a role model in his church and community. Mr. McAlilly spoke of spoke of his positive experience with Walmart and CHESCO Services.

QA Process/Incident Management Reporting

Mrs. Beck provided a presentation and an Incident Management Review Summary. She explained the difference among the critical incidents report categories. Dr. Buscemi stated the increase in critical incidents between FY 2015 and FY 2016 may be related to expansion and the increase in our service population. The Commission agreed monthly reports should be provided for their review regarding Incident Management from this point forward due to increases in incident counts. Discussion followed (Attachment B)

Finance and Audit Committee Report

Commissioner Ravenel, Chairperson of the Finance and Audit Committee, reported on the Committee Meeting that took place prior to the Commission Meeting. She stated that Mr. Kevin Yacobi gave an update of the Internal Audit findings. Commissioner Ravenel also added that the Finance and Audit Committee will meet quarterly on the budget and bring forth any recommendations to the Commission.

Financial Report

Mr. Waring gave an analysis of the agency's financial activity through February of 2016 and the agency's current financial position. The agency's operating funds balance as of February 29, 2016 is \$68,551,716. He also provided a SCEIS report categorized by program which reflects budget verses actual expenditures through February. (Attachment C)

Midlands Center Right-of-way Easement

Mr. Waring provided information of the Richland County offer to purchase the right-of-way intersection of Farrow Road and Pisgah Church Road. Discussion followed with concerns of the appraisal, offer, the timeframe

that it was brought to the Commission and the upkeep of the property. Dr. Buscemi suggested the Commission approve with conditions presented and remove the sale from the State Fiscal Accountability Authority agenda if the Commission is uncomfortable with additional information that is received.

Commissioner Davis made the motion to allow staff to proceed with the process of the sale of the land to Richland County subject to successful negotiations on outstanding right-of-way issues and subject to approval by the State Fiscal Accountability Authority. The motion was seconded and passed. (Attachment D)

Waiting List Reduction Efforts

Mrs. Beck shared waiting list data as of March 1, 2016. Mrs. Beck also provided charts with the unduplicated count of the number of individuals on the ID/RD and Community Supports Waiver Waiting Lists. Mrs. Beck presented a new Waiting List reporting format for the Commission to take into consideration. Discussion followed. The consensus of the Commission was to try the new reporting document displaying the monthly data points by fiscal year to include the pending status for a couple of months. (Attachment E)

Strategic Planning Update

Dr. Buscemi stated the agency Mission Statement was revised in the Strategic Planning session that was held yesterday, Wednesday, March 16, 2016 Dr. Buscemi explained the changes. On motion of Commissioner Lemel, seconded and passed, the changes to the Mission Statement were adopted. (Attachment F).

Dr. Buscemi spoke of the seven key areas the Commission decided would be part of the DDSN Strategic Plan which included 1) Communication; 2) Provider support/guidance training; 3) Oversight of providers; 4) Crisis Management; 5) Waiting List; 6) Recruitment and retention of qualified employees and 7) Intake process.

Recognition of Commissioners

In recognition of Commissioner Fred Lynn's service on the Commission, Commissioner Barnwell read a resolution expressing gratitude for his service on behalf of the Commission.

In recognition of Commissioner Katherine Davis' service on the Commission, Chairperson Danielson read and presented a resolution expressing gratitude for her service on behalf of the Commission.

State Director's Report

Dr. Buscemi reported on the following:

Financial Audit – An entrance conference is scheduled next week with Greene, Finney and Horton Accounting Firm. Scott and Company have finished their portion of the audit. The timeline for completion of the audit is the latter part of May.

Room and Board – 15 boards/providers have submitted plans on the overcharges for 2015. Reminders will be sent out as the plans were due at the end of February. There was no impact on the 2015 charges of eight boards/providers that submitted plans. The impact of charges on the remaining providers is approximately \$300,000.

Southern Wesleyan University – a public announcement was made this Monday about the unique collaboration of a housing/work program between Pickens County DSN Board, Anderson County DSN Board, DDSN and the University.

ABLE – the ABLE bill passed out of the Senate Finance Committee this week. It will next be taken up by the full Senate. The bill has already passed the House. Hopefully the bill will be passed by the General Assembly this year.

Executive Session

On motion of Commissioner Lemel, seconded and passed, the Commission entered into Executive Session to discuss a contractual matter regarding SC Mentor.

Enter into Public Session

The Commission entered into Public Session. It was noted that no action was taken in the Executive Session.

Adjournment

With no further business, Commissioner Danielson adjourned the meeting.

Submitted by,

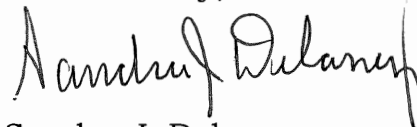

Sandra J. Delaney

Approved:

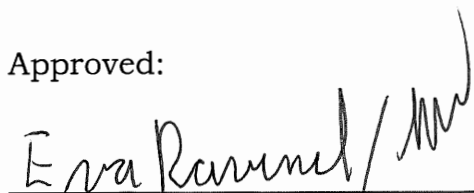

Commissioner Eva Rayenel
Secretary

SC COMMISSION ON DISABILITIES AN
Commission Meeting

Attachment 1

March 17, 2016

Guest Registration Sheet

(PLEASE PRINT)

Name and Organization

1. Lisa Weeks - DDSN
2. Marty Rawls - DDSN
3. CHUCK NORMAN - DDSN
4. CASEY STERNENBERG - DPN
5. Shantenna Jeff KCDSN
6. Deborah & Heatre McPherson - Richland county
7. Dorothy Goodwin - Community Options, Inc
8. Angela Jacildone SC Spinal Cord Injury Assoc.
9. KATHLEEN ROBERTS ~~SCDHHS~~ WHITTEN CENTER - SC PPD
10. Zenobia Corby Kershaw County DSN
11. Kelly Eifert SCDHHS
12. Ben Orvek DDSN
13. Connie Coleman Newberry DSN Board
14. Cheryl Nicholas Newberry DSN Board
15. Joe White Cherokee County DSNB
16. Terry Rogers CHESCO Services
17. Amarie Whyte Walmart
18. Mike Watson CHESCO Services
19. John Davis CHESCO Services
20. Sammie Murrell III Chesco Services

SC COMMISSION ON DISABILITIES AND SPECIAL NEEDS

Commission Meeting

March 17, 2016

Guest Registration Sheet

(PLEASE PRINT)

Name and Organization

- | | | |
|-----|--------------------|-------------------------|
| 21. | Margie Williamson | The Arc of SC |
| 22. | Rayhan Miller | DD Council |
| 23. | Mike Keith | Merion Dillon DSN |
| 24. | Cassidy Evans | DHHS |
| 25. | Jennifer VanCleave | LGPA |
| 27. | Ratir Fryssury | |
| 28. | Catrina Britton | DHHS |
| 29. | Ann Dalton | DHHS |
| 30. | Joyce Davis | BIASC |
| 31. | Julie Brown | |
| 32. | Dorothy Parker | ARSDSIB |
| 33. | Rick Brunelrott | Greenville News |
| 34. | Suzanne Hyma | Project HOPE Foundation |
| 35. | Beth Bunge | Bright Start |
| 36. | Gerold Bernard | Charleston Center |
| 37. | Melissa Hallbeck | Babcock Center |
| 38. | Jena Martin | Family Connection |
| 39. | Ric 2 Magnus | Chas - DSN Board |
| 40. | Crysal Zwick | CHESCO - services |

SC COMMISSION ON DISABILITIES AND SPECIAL NEEDS

Commission Meeting

March 17, 2016

Guest Registration Sheet

(PLEASE PRINT)

Name and Organization

1. Melinda Moore Air of the Midlands

2. _____

3. _____

4. _____

5. _____

6. _____

7. _____

8. _____

9. _____

10. _____

11. _____

12. _____

13. _____

14. _____

15. _____

16. _____

17. _____

18. _____

19. _____

20. _____

SC COMMISSION ON DISABILITIES AND
Commission Meeting
March 17, 2016

Guest Registration Sheet

(PLEASE PRINT) Name and Organization

- 1. Sloan Todd Path Finders
- 2. Gloria M. James Bamberg Co. DSN Bd.
- 3. Felita Martino Dist. II
- 4. Hester Wonnaker Dist II
- 5. Rufus Brett III Dist. II
- 6. Ronda Ritchie Dist II
- 7.
- 8.
- 9.
- 10.
- 11.
- 12.
- 13.
- 14.
- 15.
- 16.
- 17.
- 18.
- 19.
- 20.

SC COMMISSION ON DISABILITIES AND
Commission Meeting
March 17, 2016

Guest Registration Sheet

(PLEASE PRINT) Name and Organization

- 1. Elizabeth Krauss Georgetown DSN
- 2. Frank HOLSCLAW Georgetown DSN
- 3. Judy Leigh Georgetown DSN
- 4. Thoma Wilh... Georgetown DSN
- 5. _____
- 6. _____
- 7. _____
- 8. _____
- 9. _____
- 10. _____
- 11. _____
- 12. _____
- 13. _____
- 14. _____
- 15. _____
- 16. _____
- 17. _____
- 18. _____
- 19. _____
- 20. _____

**SC COMMISSION ON DISABILITIES AND
Commission Meeting
March 17, 2016**

Guest Registration Sheet

(PLEASE PRINT) Name and Organization

- 1. Ann Annan, Lee Co DSN Board
- 2. Elizabeth K. Smith DDSN District II
- 3. Debra Wolf Clarendon County DSN
- 4. J Hill SCDDSN
- 5. _____
- 6. _____
- 7. _____
- 8. _____
- 9. _____
- 10. _____
- 11. _____
- 12. _____
- 13. _____
- 14. _____
- 15. _____
- 16. _____
- 17. _____
- 18. _____
- 19. _____
- 20. _____

SC COMMISSION ON DISABILITIES AND
Commission Meeting
March 17, 2016

Guest Registration Sheet

(PLEASE PRINT) Name and Organization

1. Elaine m. Thena PCBDSN

2.

3.

4.

5.

6.

7.

8.

9.

10.

11.

12.

13.

14.

15.

16.

17.

18.

19.

20.

**SC COMMISSION ON DISABILITIES AND
Commission Meeting
March 17, 2016**

Guest Registration Sheet

(PLEASE PRINT) Name and Organization

Jimmy Bart *Bart Center*

2. _____

3. _____

4. _____

5. _____

6. _____

7. _____

8. _____

9. _____

10. _____

11. _____

12. _____

13. _____

14. _____

15. _____

16. _____

17. _____

18. _____

19. _____

20. _____

SOUTH CAROLINA COMMISSION ON DISABILITIES AND SPECIAL NEEDS

A G E N D A

**South Carolina Department of Disabilities and Special Needs
3440 Harden Street Extension
Conference Room 251
Columbia, South Carolina**

March 17, 2016

10:00 A.M.

1. Call to Order *Chairperson Bill Danielson*
2. Welcome - Notice of Meeting Statement *Commissioner Eva Ravenel*
3. Invocation *Commissioner Mary Ellen Barnwell*
4. Introduction of Guests
5. Adoption of Agenda
6. Approval of the Minutes of the February 18, 2016 Commission Meeting
7. Public Input
8. Commissioners' Update *Commissioners*
9. Business:
 - A. Disability Advocacy Day *Ms. Connie Coleman
IMPACT of South Carolina
Ms. Margie Williamson
Executive Director
The ARC of South Carolina
Dr. Beverly Buscemi*
 - B. Consumer Recognition *Mr. Terry Rogers
Executive Director
CHESCO Services*
 - C. Employment Showcase *Ms. Susan Beck*
 - D. QA Processes/Incident Management Reporting *Commissioner Eva Ravenel*
 - E. Finance and Audit Committee Report *Mr. Tom Waring*
 - F. Financial Report *Mr. Tom Waring*
 - G. Midlands Center Right-of-way Easement *Ms. Susan Beck*
 - H. Waiting List Reduction Efforts *Dr. Beverly Buscemi*
 - I. Strategic Planning Update *Chairperson Bill Danielson*
 - J. Recognition of Commissioners
10. State Director's Report *Dr. Beverly Buscemi*
11. Executive Session
12. Next Regular Meeting (April 21, 2016)
13. Adjournment

DSN Incident Management Review Summary

3/17/16

ABUSE, NEGLECT, AND EXPLOITATION REPORTING

DDSN has a comprehensive system for collecting data related to abuse, neglect exploitation or other critical incidents. This review covers reporting within the appropriate time frames, completion of internal reviews, and a review of the provider's management action taken, staff training, risk management and quality assurance activities to provide safeguards for the consumers.

- DDSN follows the procedures for reporting allegations of Abuse, Neglect, and Exploitation according to the procedures outlined in the SC Code of Law for Adult/ Child Protective services and the Omnibus Adult Protection Act. The agency also has a system to capture reports of other critical incidents that do not meet the definitions of an abuse, neglect or exploitation allegation.
- Per 534-02-DD, for all allegations of abuse, neglect or exploitation, the alleged perpetrator must be immediately placed on Administrative Leave Without Pay. Based on the outcome of the internal review for improper conduct and any policy or procedural violations, the provider agency may take appropriate disciplinary action consistent with their human resource policies. Allegations substantiated by SLED, Local Law Enforcement or DSS must result in termination of the employee.

TRACKING AND TRENDING REPORTS

DDSN tracks, trends, and analyzes all Incident Management data through statewide and provider-level profile reports. These reports provide raw data with regard to the number of reports made and cases substantiated and also gives a rate per 100 ratio. As an additional measure, the reports breakdown the types of abuse cases within the provider agency and the number of each type of report. A listing of the top four types of reports for the provider and the state as a whole is given for additional comparison. The rate per 100 information is especially useful in providing a comparative analysis among agencies.

- Over the past 5 years, the number of statewide ANE Allegations per 100 individuals in residential services has dropped from a high of 11.47 to a low of 8.78 in FY14. For FY15, the rate per 100 was 9.9. For the first half of FY16, the rate is 4.4.
- The rate of substantiated abuse per 100 individuals in residential services remains under .25.
- The number of ANE Allegations per 100 individuals in day services remains below 1%. For FY14, the rate was .97. FY15 dropped to .84, and the first half of FY16 reflects a rate of .38.
- The rate of substantiated abuse per 100 individuals in day services remains around .03 to .05. There have been no substantiated allegations of ANE in Day Services in FY16.

CRITICAL INCIDENT REPORTING

A Critical Incident is defined as an unusual, unfavorable occurrence that is not consistent with routine operations; has harmful or otherwise negative effects involving people with disabilities, employees, or property; and occurs during the direct provision of DDSN service.

It is also important to remember that Critical Incident numbers are not unduplicated numbers. Critical Incident categories are selected by the reporter and more than one category may be selected for an incident. For example, a van accident would be reported under Motor Vehicle Accidents, but it may also involve injuries and possibly Major Medical. Aggression between 2 consumers may result in Law Enforcement involvement and a report of injuries.

- Statewide, about 15 – 17% of our service population will have a Critical Incident of some type each year. The numbers are higher for the Regional Centers due to the medically complex needs and/or behavioral challenges presented by some residents.
- For FY15, approximately 38% of all critical incidents were related to major medical or hospitalization related reports. For the first half of FY16, approximately 36% of the reports fall into this category.
 - The majority of incidents reported to DDSN are for medical issues, accidents, and injuries. Major medical incidents have been steadily increasing, but this is largely impacted by our agency's aging population and increasing medical needs.
 - There have been more people admitted to the hospital for pneumonia or other respiratory infections, an increase in consumers receiving Hospice care in their DDSN home as opposed to a nursing home, and other medical conditions typically associated with older adults.
- DDSN Continues to monitor reports of aggression among consumers supported by the agency. For FY15, approximately 11% of the total number of critical incidents reported were related to consumer aggression. For the first part of FY11, the number remains consistent at about 11%.

DDSN REVIEW

DDSN has staff dedicated to the review of statewide incident management data. All reports are reviewed for completeness and consistency and to ensure appropriate disciplinary actions, recommendations for training and additional quality management actions to prevent recurrence. Staff ensure reporting procedures are consistent with DDSN policy. Reports are also tracked for various details, including the number of reports, by type, for each provider and other characteristics.

Examples of provider training recommendations and/ QM efforts include the following:

- Increased staffing to support consumers in day or residential locations or on community outings
- Development of new/revised policies
- Additional/ refresher MANDT or crisis intervention training for staff
- Sensitivity training
- Appropriate use of restraints
- Rights/ due process
- Sign language
- Revision of supervision plans/ behavior support
- Evaluation of assistive technology

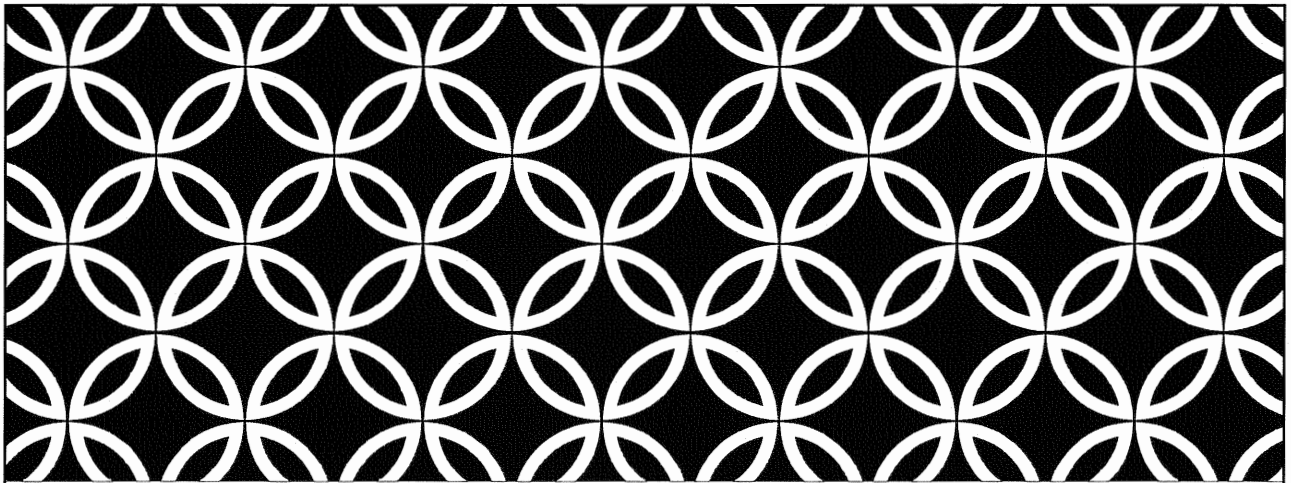

SCDDSN INCIDENT MANAGEMENT REPORTING

- Critical Incidents
- Allegations of Abuse, Neglect, and Exploitation
- Death Reporting

SCDDSN INCIDENT MANAGEMENT REPORTING

DDSN has a comprehensive system for collecting data related to abuse, neglect exploitation or other critical incidents. This review covers reporting within the appropriate time frames, completion of internal reviews, and a review of the provider's management action taken, staff training, risk management and quality assurance activities to provide safeguards for the consumers.

DDSN follows the procedures for reporting allegations of Abuse, Neglect, and Exploitation according to the procedures outlined in the SC Code of Law for Adult/ Child Protective services and the Omnibus Adult Protection Act.

SCDDSN INCIDENT MANAGEMENT REPORTING

DDSN tracks, trends, and analyzes all Incident Management data through statewide and provider-level profile reports. These reports provide raw data with regard to the number of reports made and cases substantiated and also gives a rate per 100 ratio. As an additional measure, the reports breakdown the types of abuse cases within the provider agency and the number of each type of report. A listing of the top four types of reports for the provider and the state as a whole is given for additional comparison. The rate per 100 information is especially useful in providing a comparative analysis among agencies.

SCDDSN INCIDENT MANAGEMENT REPORTING

ANE Reports- Disciplinary Action Taken

Per 534-02-DD, for all allegations of abuse, neglect or exploitation, the alleged perpetrator must be immediately placed on Administrative Leave Without Pay. Based on the outcome of the internal review for improper conduct and any policy or procedural violations, the provider agency may take appropriate disciplinary action consistent with their human resource policies. Allegations substantiated by SLED, Local Law Enforcement or DSS must result in termination of the employee.

The following slides represent the total number of allegations reported and the number of cases substantiated by a State Investigative Agency, divided by location type. Based on these findings, 6 staff were terminated due to substantiated abuse, neglect or exploitation. As additional 50 staff were terminated throughout the DDSN due to policy or procedural violations or other improper conduct towards a consumer.

SCDDSN INCIDENT MANAGEMENT REPORTING

Community Residential Services -Allegations of Abuse, Neglect, Exploitation

	<u>FY 12</u>	<u>FY 13</u>	<u>FY14</u>	<u>FY15</u>	<u>FY16</u>
# Reports	412	493	383	438	195
Rate Per 100	9.72	11.47	8.78	9.88	4.37
Allegations Substantiated	8	1	11	4	0
Rate Per 100	0.19	0.02	0.25	0.09	0

SCDDSN INCIDENT MANAGEMENT REPORTING

Allegations reported for Community Residential Service Providers

Substantiated Allegations for Community Residential Service Providers

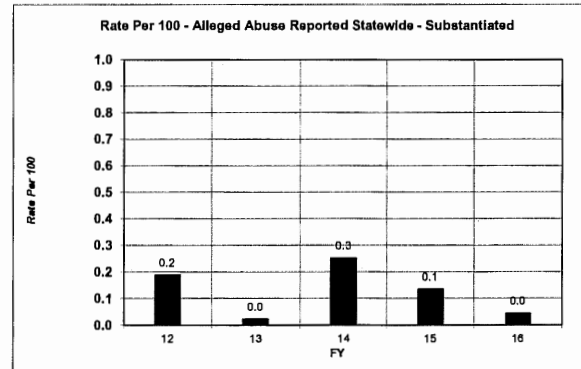
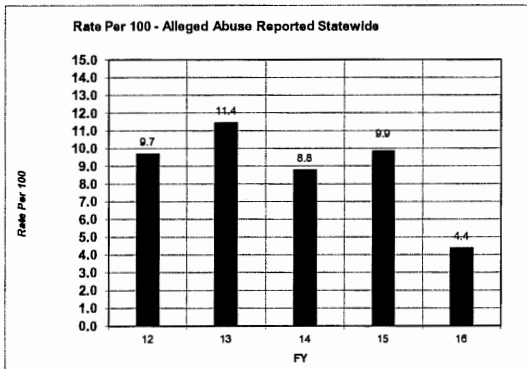

SCDDSN INCIDENT MANAGEMENT REPORTING

Most frequently types of abuse reported- Statewide Residential

	Physical	Neglect	Psychological	Exploitation
FY 12	197	103	92	42
	Physical	Neglect	Psychological	Exploitation
FY 13	200	162	109	68
	Physical	Neglect	Psychological	Exploitation
FY 14	171	128	77	43
	Physical	Neglect	Exploitation	Psychological
FY 15	209	116	63	56
	Physical	Neglect	Psychological	Exploitation
FY 16	125	71	56	25

SCDDSN INCIDENT MANAGEMENT REPORTING

Day Services- Allegations of Abuse, Neglect and Exploitation

	FY 12	FY 13	FY14	FY15	FY16 <small>(YTD)</small>
# Reported	71	61	73	65	29
Rate Per 100	0.96	0.82	0.97	0.58	0.38
# Allegations Substantiated	2	2	4	4	0
Rate Per 100	0.03	0.03	0.05	0.05	0.0

SCDDSN INCIDENT MANAGEMENT REPORTING

Allegations reported for Community Day Services

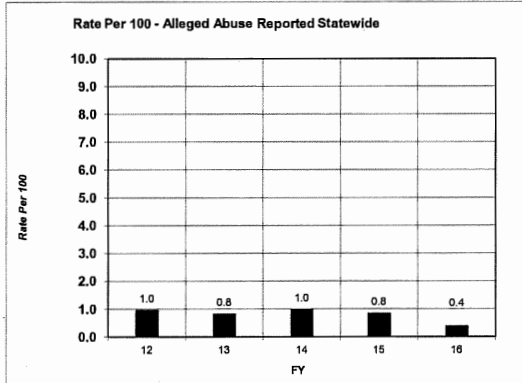

Substantiated Allegations for Community Day Service Providers

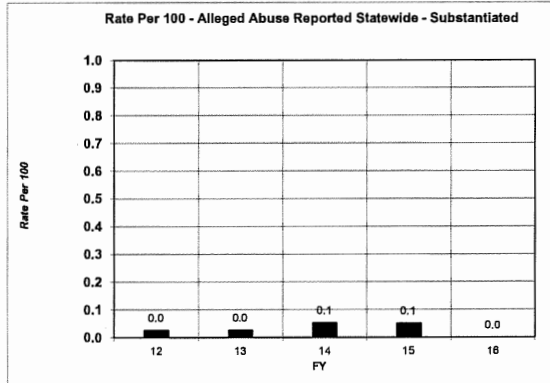

SCDDSN INCIDENT MANAGEMENT REPORTING

Most frequently types of abuse reported- Statewide Day

	Physical	Neglect	Psychological	Sexual/Exp
FY 12	38	17	11	4 ea
FY 13	25	19	10	10 Psychological
FY 14	37	16	13	5 Sexual
FY 15	25	21	15	5 Sexual
FY 16	17	8	4	

SCDDSN INCIDENT MANAGEMENT REPORTING

ABUSE, NEGLECT, EXPLOITATION reported by Regional Centers

	FY 12	FY 13	FY14	FY15	FY16 (YTD)
# Allegations Reported	137	111	167	102	49
Rate Per 100	16.8	14.0	22.1	13.5	7.1
# Allegations Substantiated	0	1	0	0	2
Rate Per 100 (Substantiated)	0.0	0.1	0.0	0.0	.3

SCDDSN INCIDENT MANAGEMENT REPORTING

Allegations reported for Regional Centers

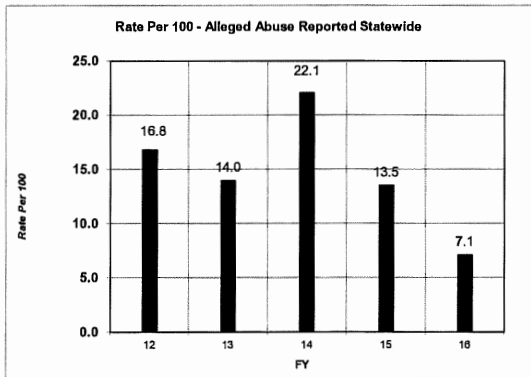

Substantiated Allegations for Regional Centers

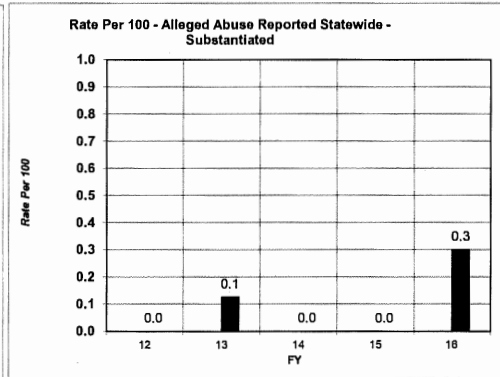

SCDDSN INCIDENT MANAGEMENT REPORTING

ANE Reports- Disciplinary Action Taken

Per 534-02-DD, for all allegations of abuse, neglect or exploitation, the alleged perpetrator must be immediately placed on Administrative Leave Without Pay. Based on the outcome of the internal review for improper conduct and any policy or procedural violations, the provider agency may take appropriate disciplinary action consistent with their human resource policies. Allegations substantiated by SLED, Local Law Enforcement or DSS must result in termination of the employee.

Disciplinary actions for DDSN and its provider agency personnel have been summarized based on actions documented in the Incident Management System.

Community Residential & Day	FY14	FY15	FY16 <small>(7/1/15-12/31/15)</small>
Termination	79	83	28
Resignation	1	7	2
Written Warning	15	39	7
Verbal Counseling	6	7	7
Suspension	5	17	6
Other disciplinary action	11	47	18

Regional Centers	FY14	FY15	FY16 <small>(7/1/15-12/31/15)</small>
Termination	17	16	12
Written Warning	4	13	13
Suspension	1	4	2
Other disciplinary action	3	19	12

SCDDSN INCIDENT MANAGEMENT REPORTING

Critical Incidents

**Critical Incident numbers are not unduplicated numbers.

Critical Incident categories are selected by the reporter and more than one category may be selected for an incident. For example, a van accident would be reported under Motor Vehicle Accidents, but it may also involve injuries and possibly Major Medical. Aggression between 2 consumers may result in Law Enforcement involvement and a report of injuries.

SCDDSN INCIDENT MANAGEMENT REPORTING

Critical Incidents reported by Community Providers (DSN Boards and Qualified Providers)

	<u>FY 12</u>	<u>FY 13</u>	<u>FY14</u>	<u>FY15</u>	<u>FY16</u> (YTD)
# Incidents Reported	1,325	1,338	1,277	1,381	726
Rate Per 100	16.8	16.9	15.8	16.5	8.7

Major medical incidents have been steadily increasing, but this is impacted by our agency's aging population and increasing medical needs. There have been more people admitted to the hospital for pneumonia or other respiratory infections, an increase in consumers receiving Hospice care in their DDSN home as opposed to a nursing home, and other medical conditions typically associated with older adults. DDSN staff trend this data and work with program staff to provide appropriate training and technical assistance where needed.

SCDDSN INCIDENT MANAGEMENT REPORTING

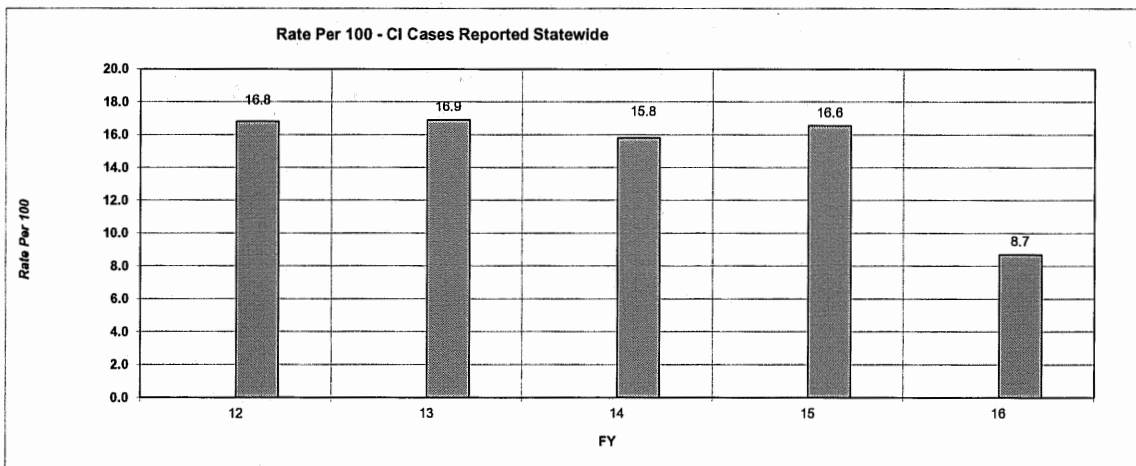

SCDDSN INCIDENT MANAGEMENT REPORTING

Types of Critical Incident Reports most frequently submitted by Community-Based Providers

	MM	Agg	Inj	Oth
FY 12	475	142	135	130
	MM	Hsp	Agg	Fall
FY 13	391	208	124	115
	MM	Hsp	Inj	Agg
FY 14	277	239	134	116
	Hsp	MM	Oth	Agg
FY 15	270	257	154	148
	Hsp	MM	Oth	LE
FY 16	132	129	102	75

SCDDSN INCIDENT MANAGEMENT REPORTING

CRITICAL INCIDENTS reported by Regional Centers

	FY 12	FY 13	FY14	FY15	FY16
# Incidents Reported	216	248	224	240	150
Rate Per 100	26.5	31.2	29.6	31.9	21.8

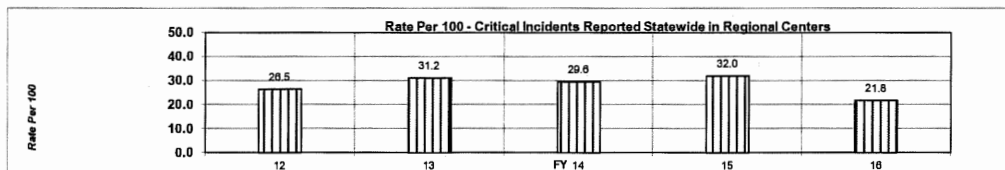

In September 2011, DDSN revised the Critical Incident Directive to include additional criteria under major medical to better track this information. The revised criteria include hospital admissions of 3 or more days or more than 2 ER visits in a 30 day period. This change had a much larger impact on DDSN Regional Centers than the community providers.

SCDDSN INCIDENT MANAGEMENT REPORTING

Deaths reported by Community Providers (DSN Boards and Qualified Providers)

	<u>FY 11</u>	<u>FY 12</u>	<u>FY 13</u>	<u>FY14</u>	<u>FY15</u>
# Deaths Reported	57	48	67	59	65
Rate Per 100	1.34	1.13	1.56	1.35	1.47

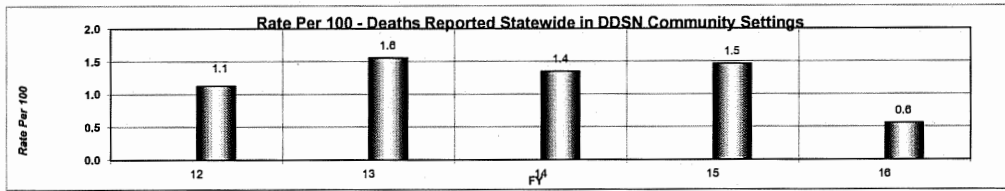

For both community residential settings and regional centers, DDSN has observed a slight increase in the number of deaths reported. DDSN providers support a population that is aging in place rather than moving to a nursing home. Many residents receive Hospice care in their DDSN sponsored setting, rather than moving to a Hospice setting. DDSN has also observed more deaths related to cardiac disease.

SCDDSN INCIDENT MANAGEMENT REPORTING

DEATHS reported by Regional Centers

	<u>FY 12</u>	<u>FY 13</u>	<u>FY14</u>	<u>FY15</u>	<u>FY16</u>
# Deaths Reported	23	20	31	31	14
Rate Per 100	2.8	2.5	4.1	4.1	2.0

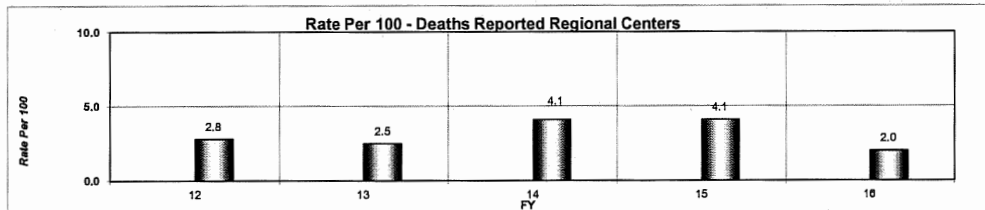

SCDDSN INCIDENT MANAGEMENT REPORTING

DDSN has staff dedicated to the review of statewide incident management data. All reports are reviewed for completeness and consistency. Staff ensure reporting procedures are consistent with DDSN policy.

Reports are reviewed to ensure appropriate disciplinary actions, recommendations for training and additional quality management actions to prevent recurrence.

Reports are also tracked for various details, including the number of reports, by type, for each provider and the average age of consumers involved in incidents.

Examples of provider training recommendations and/ QM efforts include the following:

- Increased staffing to support consumers in day or residential locations or on community outings.
- Development of new/ revised policies
- Additional/ refresher MANDT or crisis intervention training for staff
- Sensitivity training
- Appropriate use of restraints
- Rights/ due process
- Sign language
- Revision of supervision plans/ behavior support
- Evaluation of assistive technology

**FINANCIAL POSITION ANALYSIS - OPERATING FUNDS
FY 2016 AS OF 2/29/2016**

	State Fund Revenue (Appropriations)	Earned Medicaid Revenue	Other Funds and One-Time Carry Forward	Federal and Restricted Funds	Total
Activity through 2/29/2016					
Revenue	\$223,026,113	\$242,532,407	\$2,646,136	\$326,371	\$468,531,027
Carry Forward	\$1,030,471	\$1,912,919	\$2,664,601	\$135,055	\$5,743,046
Interfund Loan	(\$38,250,000)	\$38,000,000		\$250,000	\$0
Personal Services Expense	(\$30,781,593)	(\$9,774,494)	(\$32,976)	(\$158,724)	(\$40,747,788)
Fringe & Benefit Expense	(\$12,397,920)	(\$4,174,733)		(\$65,916)	(\$16,638,568)
Other Operating Expense	(\$89,637,500)	(\$258,262,297)	(\$435,017)	(\$1,186)	(\$348,336,000)
Balance as of 2/29/2016 per Financial System	\$52,989,571	\$10,233,802	\$4,842,744	\$485,599	\$68,551,716

FM Budget vs Actual										
Author JGRANT			Status of Data 3/1/2016 04:39:32							
<input type="button" value="Chart"/> <input type="button" value="Filter"/> <input type="button" value="Information"/>										
Table										
Fiscal year	Business area	Funded Program - Bud	Fund (High Level)	Original Budget	Budget Adjustments	Current Budget	YTD Actual Expense	Balance Before Commitments	Commitments and Other Transactions	Remaining Balance
2016	DDSN	ADMINISTRATION	GENERAL FUND	\$ 3,943,324	\$ 96,400	\$ 4,039,724	\$ 2,680,895	\$ 1,358,829		\$ 1,358,829
			EARMARKED FUNDS	\$ 3,335,645	-\$ 56,160	\$ 3,279,485	\$ 1,328,816	\$ 1,950,669	\$ 564,911	\$ 1,385,758
			Result	\$ 7,278,969	\$ 40,240	\$ 7,319,209	\$ 4,009,711	\$ 3,309,498	\$ 564,911	\$ 2,744,587
		PREVENTION PROGRAM	EARMARKED FUNDS	\$ 257,098	\$ 356,702	\$ 613,800	\$ 513,799	\$ 100,001	\$ 100,001	\$ 0
			Result	\$ 257,098	\$ 356,702	\$ 613,800	\$ 513,799	\$ 100,001	\$ 100,001	\$ 0
		GWOOD GENETIC CTR	GENERAL FUND	\$ 3,434,300	\$ 0	\$ 3,434,300	\$ 2,875,729	\$ 558,571	\$ 408,571	\$ 150,000
			EARMARKED FUNDS	\$ 6,534,076	\$ 0	\$ 6,534,076	\$ 4,531,054	\$ 2,003,022	\$ 2,003,022	\$ 0
			Result	\$ 9,968,376	\$ 0	\$ 9,968,376	\$ 7,406,783	\$ 2,561,593	\$ 2,411,593	\$ 150,000
		CHILDREN'S SERVICES	GENERAL FUND	\$ 3,053,909	\$ 800	\$ 3,054,709	\$ 2,253,678	\$ 801,031	\$ 0	\$ 801,031
			EARMARKED FUNDS	\$ 11,582,226	\$ 6,593,080	\$ 18,175,306	\$ 4,615,597	\$ 13,559,709	\$ 320	\$ 13,559,389
			FEDERAL FUNDS	\$ 223,000	\$ 0	\$ 223,000	\$ 0	\$ 223,000	\$ 0	\$ 223,000
			Result	\$ 14,859,135	\$ 6,593,880	\$ 21,453,015	\$ 6,869,276	\$ 14,583,739	\$ 320	\$ 14,583,419
		Babynet	GENERAL FUND	\$ 3,725,000	\$ 0	\$ 3,725,000	\$ 3,725,000	\$ 0	\$ 0	\$ 0
			EARMARKED FUNDS	\$ 5,587,500	\$ 0	\$ 5,587,500	\$ 3,628,599	\$ 1,958,901	\$ 0	\$ 1,958,901
			Result	\$ 9,312,500	\$ 0	\$ 9,312,500	\$ 7,353,599	\$ 1,958,901	\$ 0	\$ 1,958,901
		IN-HOME FAMILY SUPP	GENERAL FUND	\$ 36,998,158	\$ 309,114	\$ 37,307,272	\$ 17,816,936	\$ 19,490,336	\$ 6,988,606	\$ 12,501,730
			EARMARKED FUNDS	\$ 39,332,737	-\$ 8,874,290	\$ 30,458,447	\$ 7,312,392	\$ 23,146,055	\$ 206,310	\$ 22,939,745
			FEDERAL FUNDS	\$ 10,000	\$ 0	\$ 10,000	\$ 0	\$ 10,000	\$ 0	\$ 10,000
			Result	\$ 76,340,895	-\$ 8,565,176	\$ 67,775,719	\$ 25,129,328	\$ 42,646,391	\$ 7,194,916	\$ 35,451,475
		ADULT DEV&SUPP EMPLO	GENERAL FUND	\$ 15,179,630	\$ 9,405,514	\$ 24,585,144	\$ 17,276,860	\$ 7,308,284	\$ 0	\$ 7,308,284
			EARMARKED FUNDS	\$ 49,215,777	\$ 150,000	\$ 49,365,777	\$ 33,348,844	\$ 16,016,933	\$ 0	\$ 16,016,933
			Result	\$ 64,395,407	\$ 9,555,514	\$ 73,950,921	\$ 50,625,704	\$ 23,325,217	\$ 0	\$ 23,325,217
		SERVICE COORDINATION	GENERAL FUND	\$ 6,566,847	\$ 1,173,200	\$ 7,740,047	\$ 4,881,499	\$ 2,858,548	\$ 968,982	\$ 1,889,565
			EARMARKED FUNDS	\$ 16,140,763	\$ 48,227	\$ 16,188,990	\$ 8,279,241	\$ 7,909,749	\$ 0	\$ 7,909,749
			Result	\$ 22,707,610	\$ 1,221,427	\$ 23,929,037	\$ 13,160,741	\$ 10,768,296	\$ 968,982	\$ 9,799,314
		AUTISM SUPP PRG FY10	GENERAL FUND	\$ 4,649,334	\$ 10,400	\$ 4,659,734	\$ 1,662,086	\$ 2,997,648	\$ 315,488	\$ 2,682,160
			EARMARKED FUNDS	\$ 9,458,972	-\$ 1,000,000	\$ 8,458,972	\$ 4,626,721	\$ 3,832,251	\$ 0	\$ 3,832,251
			FEDERAL FUNDS	\$ 5,000	\$ 0	\$ 5,000	\$ 0	\$ 5,000	\$ 0	\$ 5,000
			Result	\$ 14,113,306	-\$ 989,600	\$ 13,123,706	\$ 6,288,807	\$ 6,834,899	\$ 315,488	\$ 6,519,410
		Pervasive Developmen	GENERAL FUND	\$ 7,886,794	-\$ 844,562	\$ 7,042,232	\$ 4,366,150	\$ 2,676,082	\$ 1,789,764	\$ 886,318
			EARMARKED FUNDS	\$ 5,140,309	-\$ 1,840,309	\$ 3,300,000	\$ 643,157	\$ 2,656,843	\$ 60,119	\$ 2,596,724
			Result	\$ 13,027,103	-\$ 2,684,871	\$ 10,342,232	\$ 5,009,307	\$ 5,332,925	\$ 1,849,882	\$ 3,483,042
		HD&SPINL CRD INJ COM	GENERAL FUND	\$ 958,763	\$ 62,922	\$ 1,021,685	\$ 730,545	\$ 291,140	\$ 0	\$ 291,140
			EARMARKED FUNDS	\$ 2,081,769	\$ 150,000	\$ 2,231,769	\$ 1,341,579	\$ 890,190	\$ 0	\$ 890,190
			Result	\$ 3,040,532	\$ 212,922	\$ 3,253,454	\$ 2,072,124	\$ 1,181,330	\$ 0	\$ 1,181,330
		REG CTR RESIDENT PGM	GENERAL FUND	\$ 36,540,363	\$ 1,488,566	\$ 38,028,929	\$ 24,508,295	\$ 13,520,634	\$ 0	\$ 13,520,634
			EARMARKED FUNDS	\$ 34,808,202	-\$ 227,670	\$ 34,580,532	\$ 17,032,428	\$ 17,548,104	\$ 3,612,511	\$ 13,935,593
			RESTRICTED FUNDS	\$ 344,048	\$ 344,048	\$ 688,096	\$ 90,791	\$ 253,257	\$ 0	\$ 253,257
			FEDERAL FUNDS	\$ 102,000	\$ 0	\$ 102,000	\$ 1,186	\$ 100,814	\$ 0	\$ 100,814
			Result	\$ 71,450,565	\$ 1,604,944	\$ 73,055,509	\$ 41,632,700	\$ 31,422,809	\$ 3,612,511	\$ 27,810,298
		HD&SPIN CRD INJ FAM	GENERAL FUND	\$ 7,593,153	\$ 3,082,390	\$ 10,675,543	\$ 5,844,907	\$ 4,830,636	\$ 3,190,179	\$ 1,640,456
			EARMARKED FUNDS	\$ 18,165,834	-\$ 7,837,713	\$ 10,328,121	\$ 6,186,120	\$ 4,142,001	\$ 725,232	\$ 3,416,769
			Result	\$ 25,758,987	-\$ 4,755,323	\$ 21,003,664	\$ 12,031,027	\$ 8,972,637	\$ 3,915,412	\$ 5,057,225

	A	F	G	H	I	J	K	L	M	N	O	P	Q
			Fiscal year	Business area	Funded Program - Bud	Fund (High Level)	Original Budget	Budget Adjustments	Current Budget	YTD Actual Expense	Balance Before Commitments	Commitments and Other Transactions	Remaining Balance
15													
59					AUTISM COMM RES PRO	GENERAL FUND	\$ 5,323,997	\$ 26,400	\$ 5,350,397	\$ 3,380,648	\$ 1,969,749	\$ 0	\$ 1,969,749
60						EARMARKED FUNDS	\$ 18,233,612	-\$ 853,300	\$ 17,380,312	\$ 11,223,920	\$ 6,156,392	\$ 60,844	\$ 6,095,547
61						Result	\$ 23,557,609	-\$ 826,900	\$ 22,730,709	\$ 14,604,569	\$ 8,126,140	\$ 60,844	\$ 8,065,296
62					INTELL DISA COMM RES	GENERAL FUND	\$ 61,224,552	-\$ 10,005,099	\$ 51,219,453	\$ 27,820,064	\$ 23,399,389	\$ 14,436,633	\$ 8,962,756
63						EARMARKED FUNDS	\$ 225,226,675	\$ 13,391,433	\$ 238,618,108	\$ 163,892,517	\$ 74,725,591	\$ 8,061,802	\$ 66,663,789
64						RESTRICTED FUNDS		\$ 101,100	\$ 101,100	\$ 67,933	\$ 33,167		\$ 33,167
65						Result	\$ 286,451,227	\$ 3,487,434	\$ 289,938,661	\$ 191,780,514	\$ 98,158,147	\$ 22,498,435	\$ 75,659,712
66					STATEWIDE CF APPRO	GENERAL FUND		\$ 0	\$ 0		\$ 0		\$ 0
67						Result		\$ 0	\$ 0		\$ 0		\$ 0
68					STATEWIDE PAY PLAN	GENERAL FUND		\$ 0	\$ 0		\$ 0		\$ 0
69						Result		\$ 0	\$ 0		\$ 0		\$ 0
70					STATE EMPLOYER CONTR	GENERAL FUND	\$ 21,558,745	-\$ 486,331	\$ 21,072,414	\$ 12,397,920	\$ 8,674,495	\$ 0	\$ 8,674,495
71						EARMARKED FUNDS	\$ 6,809,487	\$ 0	\$ 6,809,487	\$ 4,174,733	\$ 2,634,754	\$ 0	\$ 2,634,754
72						RESTRICTED FUNDS		\$ 168,505	\$ 168,505	\$ 65,916	\$ 102,589	\$ 0	\$ 102,589
73						Result	\$ 28,368,232	-\$ 317,826	\$ 28,050,406	\$ 16,638,568	\$ 11,411,838	\$ 0	\$ 11,411,838
74					DUAL EMPLOYMENT	GENERAL FUND				\$ 0	\$ 0	\$ 0	\$ 0
75						Result				\$ 0	\$ 0	\$ 0	\$ 0
76					Autism Services	GENERAL FUND		\$ 1,000,000	\$ 1,000,000	\$ 495,800	\$ 504,200	\$ 0	\$ 504,200
77						Result		\$ 1,000,000	\$ 1,000,000	\$ 495,800	\$ 504,200	\$ 0	\$ 504,200
78					Special Needs Park -	GENERAL FUND		\$ 100,000	\$ 100,000	\$ 100,000	\$ 0	\$ 0	\$ 0
79						Result		\$ 100,000	\$ 100,000	\$ 100,000	\$ 0	\$ 0	\$ 0
80					Special Family Resou	GENERAL FUND		\$ 1	\$ 1		\$ 1		\$ 1
81						Result		\$ 1	\$ 1		\$ 1		\$ 1
82					Result		\$ 670,887,551	\$ 6,033,368	\$ 676,920,919	\$ 405,722,357	\$ 271,198,562	\$ 43,493,297	\$ 227,705,265

CONSIDERATION OF OFFER

**RICHLAND COUNTY OFFER TO PURCHASE RIGHT-OF-WAY
INTERSECTION OF FARROW ROAD AND PISGAH CHURCH ROAD
RICHLAND COUNTY, SC**

**Road/Route S.C. Route 555 & S-40-34 Intersection – Richland County
SCDOT ID: 28869 – RPP Proj. 296 – Tract 5**

On behalf of Richland County, Right-of-Way Acquisition Agent for PAN offers \$40,400.00 for fee simple title to 0.87 acres of land. The offer is based on appraisal by A.R. Martin Company.

The Department will pursue with Acquisition Agent the following items:

1. Additional land required for new SCE&G easement and power line relocation, as only a Preliminary Sketch was provided with the offer.
2. Fair compensation for replanting of landscaping lost around Midlands Center sign that must be relocated by intersection improvement contractor.
3. Fair compensation for timber lost along the right of way.
4. Written assurance that all gullies and washes will be promptly and satisfactorily repaired and re-grassed for a period of one year.

Staff recommends that permission be given to sell the requested property, subject to successful negotiations on outstanding right-of-way issues, and subject to approval by the State Fiscal Accountability Authority.

ATTACHMENT: Offer Letter
Exhibit A - Area of Acquisition

Date Received: 03/11/16

Commission Date: 03/17/16



Property Acquisitions & Negotiations

Road/Route S.C. Route 555 & S-40-34 Intersection – Richland County
SCDOT ID: 28869 – RPP Proj. 296 - Tract 5

South Carolina Department of Disabilities and Special Needs
P.O. box 4706
Columbia, SC 29240

Dear Department of Disabilities and Special Needs:

Reference is made to the above captioned project, under which the Richland County proposes to acquire a portion of your property for this improvement as has been discussed with you previously. The County must pay just compensation for the property which is based on an appraisal made by a qualified real estate appraiser using comparable sales in the area.

The appraisal, which is available to the landowner upon request, has been made, reviewed and approved, and I am now authorized to make you the following offer:

\$40,400.00 – For fee simple title to 0.87 acre (37, 759.16 sq. ft.) of land and all improvements thereon, if any.

Please give this offer your prompt attention and let me know your decision as soon as possible. Retain this information to report your payment according to IRS rules in Publication 544.

If I can be of any further assistance, do not hesitate to contact me.

Sincerely,

A handwritten signature in black ink that reads "Marcus B. Link". The signature is written in a cursive style with a circled 'L' at the end.

Marcus B. Link
Acquisition Agent
PAN, Inc.
803-726-6628
803-622-3804 (cell)

March 10, 2016
Date Offer Made

EXHIBIT "A"

5

OBTAIN • 37,759.16 S.F.
(0.87 AC.)

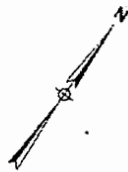

CURVE FALLOW-1
 PI Sta 15+18.54
 $\Delta = 58^\circ 53' 58.94''$ (RT)
 $D = 4^\circ 57' 20.93''$
 $L = 1188.50'$
 $T = 652.77'$
 $R = 1156.13'$
 PC Sta 8+65.76
 PT Sta 20+54.26

TIE EQUALITY
 BEGIN RELOCATED CENTERLINE
 PC STA 16+48.58 S-40-34
 (PISGAH CHURCH RD. RELOC.)
 POT STA 16+48.58 S-40-34
 (PISGAH CHURCH RD.)

CURVE PISGAH-REL-1
 PI Sta 17+61.55
 $\Delta = 29^\circ 46' 13.33''$ (RT)
 $D = 13^\circ 28' 52.90''$
 $L = 2208.3'$
 $T = 112.27'$
 $R = 425.00'$
 PC Sta 16+48.58
 PT Sta 18+69.41

TIE EQUALITY
 PC STA 20+12.46 S.C. RTE. 555
 (FALLOW RD.)
 END RELOCATED CENTERLINE
 POT STA 19+94.43 S-40-34
 (PISGAH CHURCH RD. RELOC.)

TIE EQUALITY
 POT STA 21+70.42 S.C. RTE. 555
 (FALLOW RD.)
 POT STA 20+72.94 S-40-34
 (PISGAH CHURCH RD.)

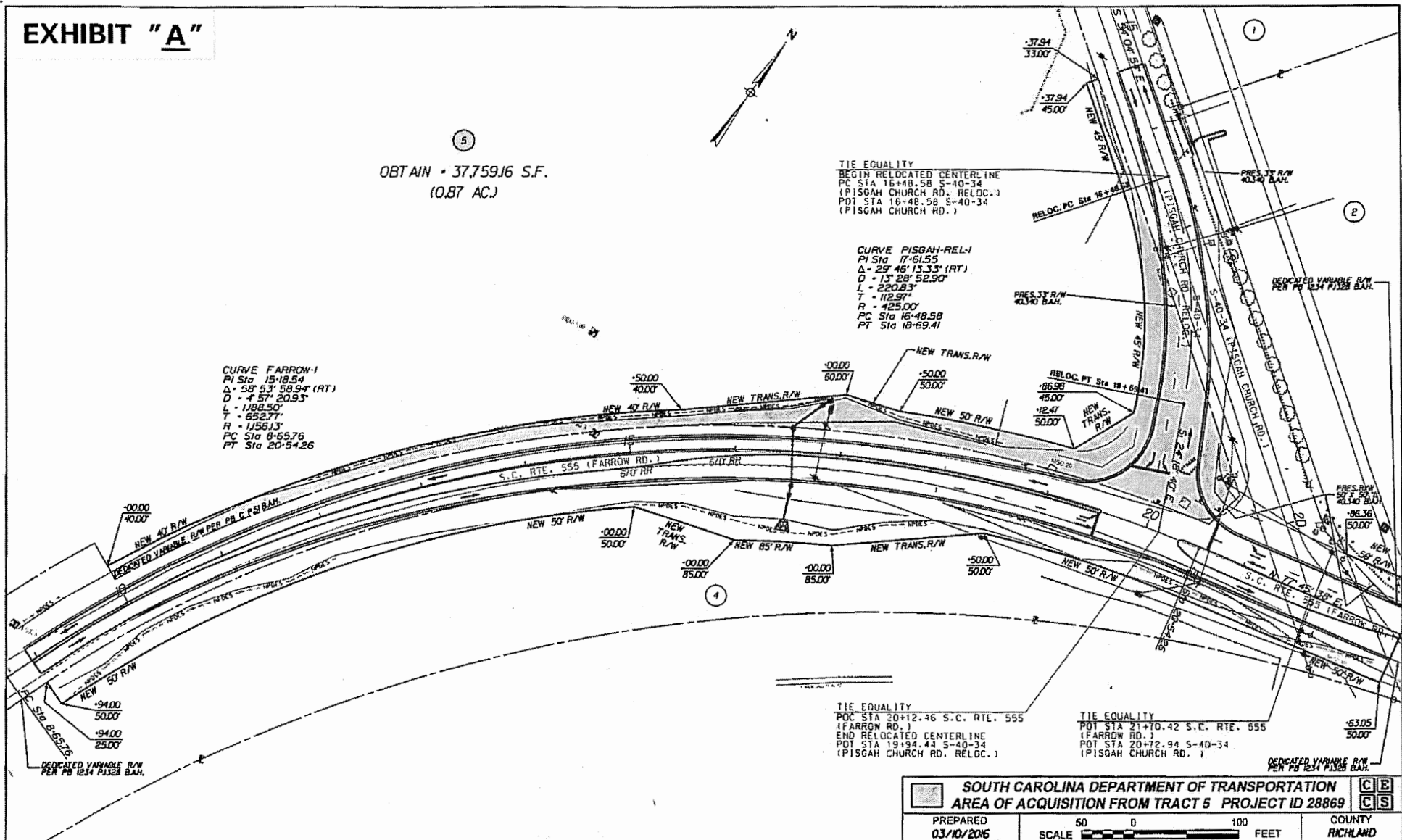

SOUTH CAROLINA DEPARTMENT OF TRANSPORTATION AREA OF ACQUISITION FROM TRACT 5 PROJECT ID 28869			COUNTY RICHLAND

SC Department of Disabilities and Special Needs
Waiting List Reduction Efforts
 As of March 1, 2016 (run on March 1, 2016)

Waiting List	Number of Individuals Removed from Waiting Lists	Consumer/Family Determination		Number of Individuals Services are Pending
		Number of Individuals Enrolled in a Waiver	Number of Individuals Opted for Other Services/ Determined Ineligible	
Intellectual Disability/Related Disabilities (As of July 1, 2014)	1,438 (FY15)	713 (FY15)	507 (FY15)	92 (FY15)
	<u>1,863 (FY16)</u> 3,301	<u>744 (FY16)</u> 1,457	<u>549 (FY16)</u> 1,056	<u>696 (FY16)</u> 788
Community Supports (As of July 1, 2014)	2,430 (FY15)	701 (FY15)	1,448 (FY15)	104 (FY15)
	<u>1,227 (FY16)</u> 3,657	<u>383 (FY16)</u> 1,084	<u>401 (FY16)</u> 1,849	<u>620 (FY16)</u> 724
Head and Spinal Cord Injury (As of Oct 1, 2013)	673	308	187	178
		2,849	3,092	
Total	7,631	5,941		1,690

Waiting List *	Number of Individuals Added Between July 1, 2014 and March 1, 2016	Number of Individuals Waiting as of March 1, 2016
Intellectual Disability/Related Disabilities	2,975 (1,201 since 7/1/15)	5,001
Community Supports	2,957 (1,126 since 7/1/15)	3,551
Head and Spinal Cord Injury	500 (147 since 7/1/15)	0
Total	6,432	8,552**

* There is currently no Head and Spinal Cord Injury (HASCI) Waiver waiting list.

** Approximately 34 percent of 8,552 are duplicated names; therefore approximately 5,635 people are on waiting lists.

**South Carolina Department Of Disabilities & Special Needs
As Of February 29, 2016**

Service List	01/31/16	Added	Removed	02/29/16
Critical Needs	122	53	42	133
Pervasive Developmental Disorder Program	1638	48	37	1649
Intellectual Disability and Related Disabilities Waiver	4935	172	105	5001
Community Supports Waiver	3501	196	146	3551
Head and Spinal Cord Injury Waiver	0	21	21	0

Report Date: 3/9/16

SC Department of Disabilities and Special Needs
 Number of Individuals on the Intellectual Disability/Related Disabilities and
 Community Supports Waiver Waiting Lists
 Unduplicated Count on March 1, 2016

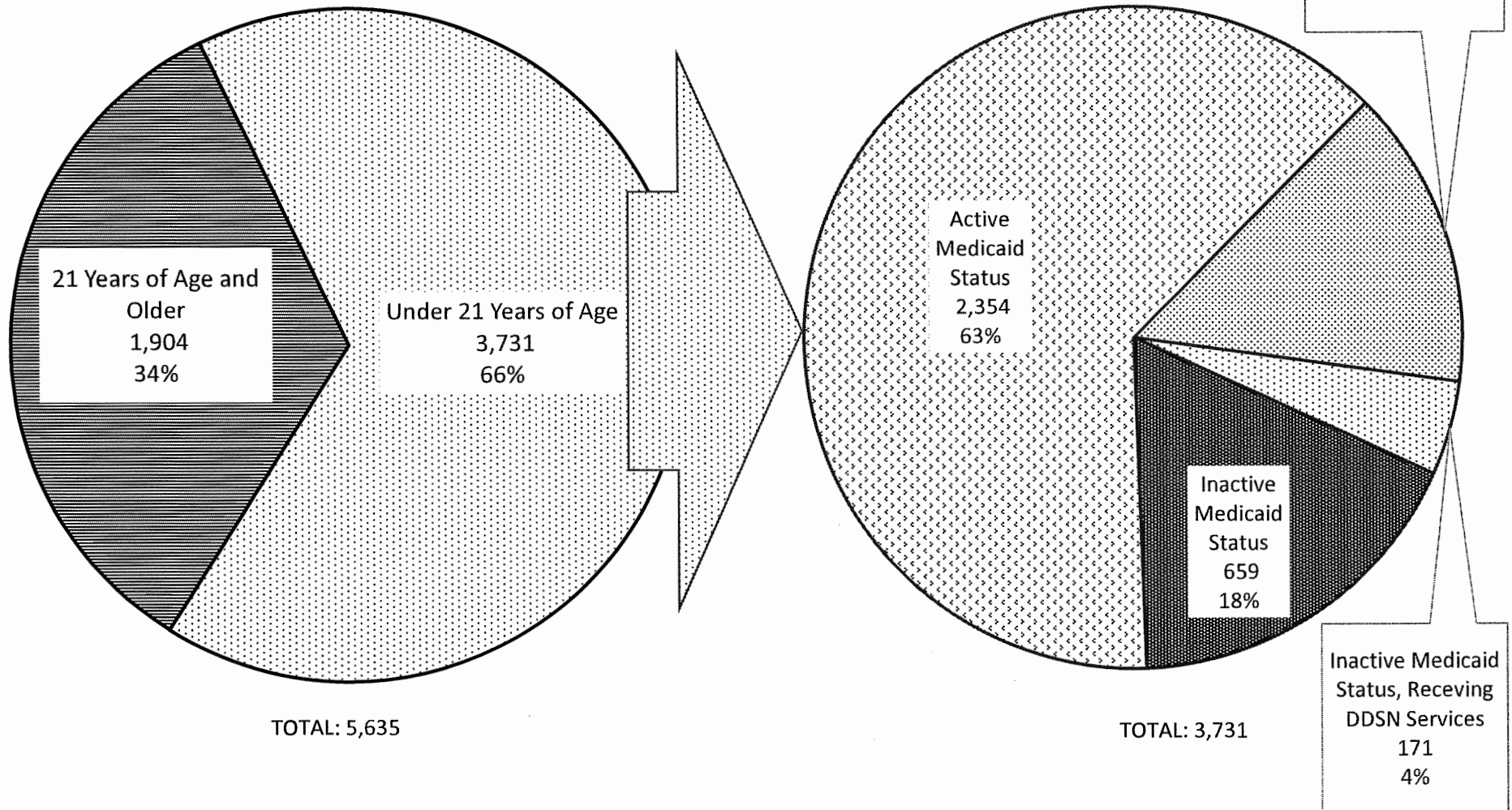

- 82% of children are receiving Medicaid Services and/or DDSN Services (2,354 + 547 + 171 = 3,072)

SC Department of Disabilities and Special Needs

Waiting List Reduction Efforts for Fiscal Year 2016

	2015						2016					
Total Numbers At Beginning of the Month	July	August	September	October	November	December	January	February	March	April	May	June
Intellectual Disability/Related Disabilities Waiver Waiting List Total	5,473	5,559	5,443	4,934	4,793	4,779	4,925	4,935	5,001			
Community Supports Waiver Waiting List Total	3,614	3,624	3,565	3,544	3,534	3,478	3,530	3,501	3,551			
Head and Spinal Cord Injury Waiver Waiting List Total	0	0	0	0	0	0	0	0	0			
Critical Needs Waiting List Total	132	131	140	122	118	124	122	122	133			
Total Number Added to the ID/RD, HASCI, and CS Waiting Lists	297	431	182	318	367	214	406	285	389			
Number of Individuals Enrolled in a Waiver Since Initiative Began	1,656	1,792	1,951	2,066	2,205	2,374	2,498	2,689	2,849			
Number of Individuals Opted for Other Services/Determined Ineligible Since Initiative Began	1,659	1,860	2,017	2,215	2,392	2,648	2,719	2,905	3,092			
Total Unduplicated Individuals on the Waiver Waiting Lists (Some Months Approximate)	6,122	6,152	6,035	5,680	5,495	5,449	5,580	5,575	5,635			

S.C. DEPARTMENT OF DISABILITIES AND SPECIAL NEEDS

The SCDDSN, as defined in the South Carolina Code of Law, serves persons with intellectual disabilities, autism, head and spinal cord injury and conditions related to each of these four disabilities.

VISION - WHERE WE ARE GOING!

To provide the very best services to assist all persons with disabilities and their families in South Carolina.

MISSION - WHAT WE DO!

Assist people with disabilities and their families through choice in meeting needs, pursuing possibilities and achieving life goals; and minimize the occurrence and reduce the severity of disabilities through prevention.

VALUES - OUR GUIDING BELIEFS!

Health, safety and well-being of each person

Dignity and respect for each person

Individual and family participation, choice, control and responsibility

Relationships with family, friends and community connections

Personal growth and accomplishments

PRINCIPLES - FEATURES OF SERVICES AND SUPPORTS

Person-centered and Community Inclusive

Responsive, efficient and accountable

Practical, positive and appropriate

Strengths-based, results-oriented

Opportunities to be productive and maximize potential

Best and promising practices